



Alpaca Fest 2011

October 29 & 30, 2011

Sponsored by the



HALTER CLASS

Registration Book

SHOW ENTRY DEADLINE: OCTOBER 3, 2011

www.ohioalpacaassociation.com

Dear Sponsors, Exhibitors, Vendors and Guests

The Ohio Alpaca Breeders Association welcomes you to the 2011 AlpacaFest. We are elated that you have chosen to be a part of our show!

Over the past fourteen years AlpacaFest has become recognized as one of the premier shows in the nation, and continues to draw participants from across the country every year. This year we will be returning to the Springfield Champions Center.

The OABA Board of Directors continues to strive to make positive advancements in the Ohio alpaca community. While some of our work is behind the scenes, most of our efforts are geared toward being front and center with our membership by providing educational as well as regionalized marketing opportunities. Educational highlights include the co-sponsorship of the Bi-Annual Veterinary Conference at the Ohio State University March of 2010. In the marketing arena, OABA continues to support the OABA Members Market at various shows throughout the year. This endeavor provides Ohio farms a retail outlet to market their alpaca products, the future of our industry at shows in Ohio.

A proud moment for us all was the introduction of the Ohio Alpaca Life magazine in 2010. The goal of the magazine is to provide a regionalized perspective on the alpaca industry, educational articles to help you grow your business and a marketing platform for our member farms. The magazine also serves as our membership directory both in print and on line so your farm can remain in front of potential customers.

AlpacaFest is the largest endeavor the organization manages each year. Careful planning of every detail takes place well in advance to ensure we host a show that spotlights the Ohio alpaca industry as the leaders in our industry. The most important part of the event is our membership. OABA receives an incredible amount of support from our volunteers and sponsors each and every year. We are so fortunate to have the support from the best group in the nation, and look forward to another successful AlpacaFest.

If we can be of any assistance while you are a guest at our show, please don't hesitate to seek out any member of the OABA Board or show management. Enjoy the show!

OABA Board of Directors:

President: Nora Custer-Haberbusch

Vice President: Lori Fish

Treasurer: Rick Johnson

Secretary: Neil Perin

Directors at Large: William Goebel, Chris Mulier, Joe Osborn, Kevin Sullivan

Registration Checklist

1. Register for stalls, show classes, and sponsorships:
 - 1.) online at: www.alpacashowreg.com/start/oaba.asp
— OR —
 - 2.) fill out and mail registration form to Nora Custer-Haberbusch (see below for address) Make check payable to OABA AlpacaFest and mail to Nora Custer-Haberbusch, Custer's Alpacas, 3283 Samuel Rd., Akron, OH 44312.
DEADLINE: Postmark must be by Monday, October 3, 2011
2. Registration for halter classes. Include copy of ARI Certificate. Mail with registration form.
DEADLINE: Postmark must be by Monday, October 3, 2011
3. Make hotel reservations. See page 15 for hotel information.
4. Prepare your ad in black and white for the Show Book (sponsorships receive a free ad) in jpeg format. Mail ad on disk to Reynne Hostetler, 8012 Beeson St. NE, Louisville, OH 44641.
DEADLINE: Postmark must be by Monday, October 3, 2011
5. All animals entered in the show must be ARI registered, have a negative BVDV PCR or VI test, be microchipped and have a Certificate of Veterinarian Inspection (health papers) completed by your veterinarian within 30 days of the last day of the show. We will need the original and one photocopy of the health papers, also please bring a copy of your ARI certificate. The health certificate must include for each alpaca, the alpaca's ARI name, the microchip number and the negative results of the BVDV PCR or VI (VI testing must have been completed prior to 1/1/2010) test. A veterinarian-supervised representative from the show will verify and examine the health certificate, the PCR or VI test result and the microchip for each alpaca in the show. This step is very important to ensure a smooth check in process. **Animals that do not meet these criteria will not be allowed to enter the building.**

All cancellations must be made in writing and sent to Nora Custer-Haberbusch, Custer's Alpacas, 3283 Samuel Rd., Akron, OH 44312

Cancellations made prior to October 21, 2011 will be charged \$50.00 plus \$15.00 per animal. No refunds for cancellations made after October 21, 2011 or for no-shows.

GENERAL AND STALLING INFORMATION

- This is an AOBA certified show. All Halter Classes will be evaluated using a comparative method using a 50/50 basis respectively for fleece and conformation. All rules or amended rules of the 2011 AOBA Show Division Handbook will be followed. We encourage you to join the AOBA Show Division and become familiar with the handbook.
- Animal substitutions will be allowed from the original Halter Class Entry Form if permission is obtained from the show superintendent, Peg Stephens at pegstephens@earthlink.net or 812/294-4880. Permission must be obtained **prior** to arriving at the show. There will be a \$25 animal substitution fee.
- Champions Center will not have an emergency phone number available the weekend of our event. If you do have an emergency, you may call Nora Custer-Haberbusch's cell phone at 216/235-0367. We ask that you restrict the use of this number to emergencies.
- Please note that no animals or exhibits will be permitted on-site prior to the Friday, October 28, 10 a.m. check-in. All exhibits and animals must be removed from the Champions Center premises by 10 p.m. on Sunday, October 30. **THERE WILL BE NO EXCEPTIONS.**
- Camping is available for \$25 a night. First come, first served. No reservations. Tent camping is not available. There are no water hookups and the restrooms will be closed. There is electric and sewer.
- The AlpacaFest Show can always use volunteers regardless of level of commitment. Volunteering is a great way to learn and network with others. If you would like to help with the halter show, please contact Nora Custer-Haberbusch at nora@custersalpacas.com or 216/235-0367. If you would like to volunteer for the fleece show, please contact Karen Mulier at karen@windylanealpacas.com or at 614/329-6824.
- There will be 10'X 12' vendor spaces available for \$149, includes electricity. For further information, contact Joe Osborn at joe4browns@aol.com or at 740/225-1337 or download the forms from OABA's Web site, <http://www.ohioalpacaassociation.com>.
- The stalls will be 10' X 10' and will have straw bedding. Exhibitors will need to provide their own stall mats. No more than three (3) yearling and older or four (4) juvenile alpacas will be allowed per stall. There will be no division of stalls. If you are sharing a stall with another farm, please indicate on the Registration Form. You must be entered in the show to rent a stall. All alpacas must be registered for a class. Due to space limitations, we cannot allow companion animals. If you are sharing a stall, have one farm reserve all the stalls including your farm display stall. If you reserve your stalls separately there are no guarantees you will be stalled together. Do not request being stalled next to another farm if you are reserving your stalls separately.
- Farm displays are welcome and encouraged. Farm displays may be reserved as 10'X 10' stalls. Only one (1) display stall will be allowed per farm. Fire safety and facility rules do not allow farm displays to extend into the aisles. Farm displays are intended to promote your farm, not retail sales. No more than 10% of your booth may be devoted to retail sales. If you need more space, please rent a vendor stall.
- Stall space is limited and assignments are made on a first-come, first-served basis, by postmark, and in accordance with the layout available to best fit the space and layout design. Grand, Platinum and Gold sponsors will receive preferred stalling. Feed and hay must be provided by exhibitor.
- Electricity and water are available at strategic points throughout the stall area. Please bring your own electric cords for fans, etc. Fans are permitted in the stalls but not in the aisle-way. A tack aisle will be located directly behind your stalls for storage of all your belongings. This aisle is closed to the public. It is the responsibility of each farm to keep their area clean at all times.
- A card will be provided for each exhibitor for security and emergency purposes. Please fill out the emergency and hotel information and affix card to your stalls.
- All animals must be vet checked on Friday and stalled for the remainder of the show. The Champions Center prohibits dogs in the buildings. No roller blades, roller skates, or skateboards, etc. are allowed in the Champions Center.
- Parents are responsible for their children. Children must be kept under supervision at all times.

SHOW AND ENTRY INFORMATION

- Halter show judges are: Nick Harrington, Huacaya males; Kristin Buhrmann, Huacaya females; Kathy Klay, all Suris and David Barboza performance class.
- An exhibitors meeting will be held at 7:30 p.m., Friday, October 28th in the show ring for the purpose of updating you on information for the show. **Attendance is mandatory.**
- We will have two (2) rings going simultaneously. One for males, one for females. A third ring will be for Performance classes. Please make sure you have enough handlers for each class.
- The handler's attire for the Halter and Showmanship classes should be conservative, neat, and appropriate for the class. No open toe shoes. The obstacle classes are very casual classes. Please dress comfortably with freedom of movement so as to easily maneuver the obstacles.
- All alpacas entered must be registered with the Alpaca Registry, Inc. and microchipped.
- All alpacas must be entered in the name of the owner as listed on the ARI Registration Certificate. Animals that are being purchased or certificates that have not been transferred must have a "Owner of Record for Show Entry Form" form signed by the owner that is listed on the ARI Registration Certificate. The form can be downloaded from the show division Web site: www.alpacashows.com. An animal may NOT be entered in any halter class more than once. Handlers other than owners do not need a owner of record form as long as the animal is entered and registered with AlpacaFest under the owners name. AOBA show rules do not allow animals with pending papers to show.
- Age of alpaca is determined from the date of the first scheduled day of judging - October 29, 2011. Because exhibitors may not know who the other exhibitors are until arrival, entry deadlines for the Get of Sire and Produce of Dam classes is 6 p.m. on Saturday, October 29th. If the exhibitor is not the owner of the Sire or Dam, written permission from the owner shown on the ARI Registration Certificate must be submitted. ARI Registration Certificate for Dam or Sire must be submitted if not entered in the show. A copy of the ARI Registration Certificate for each of the three progeny in Get of Sire and two progeny in Produce of Dam must also be provided to the Show Superintendent, if entering at the show. All offspring must be eligible and entered in their respective halter classes. Be aware that any additions will not be listed in the show book. Animals must be in full fleece.
- The Exhibitor Rule applies. The owner can enter only (3) three alpacas per breed type (Huacaya or Suri), per gender, per age division, per color designation.
- **As an exhibitor, it is your responsibility to be on time for classes.** Once the class has entered the ring and the judge and gatesman have agreed that this is the class, late exhibitors may not enter a class.
- The entry fees are:
 - \$40 per class per animal \$30 for Bred and Owned Yearling
 - \$30 for Get of Sire (3 animals) \$30 for Breeders Best of Three
 - \$30 for Produce of Dam (2 animals) \$15 for youth entered in classes designated as "Youth"
 - \$30 for Open Gelding (18+ months) *This is one fee per youth exhibitor for youth classes only.*
 - \$30 for Non-Breeding Female (18+ months) \$20 Open (Non-Youth) Performance and Exhibition classes
- Prizes will include rosette ribbon for 1st through 6th place in each class, with banners for Color and Reserve Champions.
- All entries postmarked after Monday, October 3, 2011 will be charged a late fee of \$30 for each animal entered in addition to the normal entry fee.
- Incomplete and/or incorrect entries may be assessed an additional \$25 processing and handling fee. Please ensure that your entries are correct. You are welcome to contact any of the people listed in this registration book for answers to your questions.
- AOBA requires us to assess a \$75 showing fee for all farms that are not members of the AOBA Show Division. This fee is per farm, not per animal.
- Any question about color and fiber length will be resolved at the time of check-in. **Please check your animal's color with the ARI color chart and the 2011 AOBA Show Division Handbook color definitions before filling out the class entry form.** Please review the 2011 AOBA Show Division Handbook for color definitions. The Handbook color definitions will take precedence.

TENTATIVE SCHEDULE OF EVENTS

Friday, October 28, 2011

- 8:00 a.m. - 7:30 p.m. Animal Check-in
- 6:00 p.m. - 7:30 p.m. Meet & Greet (*TBD*)
- 7:30 p.m. OABA Meeting / Exhibitors' Meeting / Sponsor Gift

Saturday, October 29, 2011

- 8:00 a.m. Fleece Show Opens
- 8:00 a.m. Performance / Halter Classes
- 9:30 a.m. - 5:00 p.m. Seminars / Workshops / Demonstrations
- Lunch Break Will Be Announced
- 5:30 p.m. End of showing for day, dinner on own.

Sunday, October 30, 2011

- 7:00 a.m. Devotions
- Location: Bleachers by Show Rings
- 9:00 a.m. - 3:00 p.m. Seminars / Workshops / Demonstrations
- 8:30 a.m. - 5:00 p.m. Halter Classes Resume
- Lunch Break Will Be Announced
- 1:00 p.m. Silent Auction Bidding Closes
- 5:00 p.m. Check-out. **CHAMPIONS CENTER REGULATIONS REQUIRE ANIMALS AND EXHIBITS MUST BE REMOVED BY 10:00 p.m. THERE WILL BE NO EXCEPTIONS.**

SOME ALPACAFEST SPEAKERS AND TOPICS

Check the OABA Web page for a list of topics, speakers and times.

BECOME A SPONSOR!

Feel free to e-mail Nora Custer-Haberbusch (nora@custersalpacas.com) with any questions. Forms are available online at <http://www.ohioalpacaassociation.com>, send completed form and check payable to OABA to Nora Custer-Haberbusch, Custer's Alpacas, 3283 Samuel Rd., Akron, OH 44312.

GRAND SPONSOR: \$1,000

- 2 free stalls
- Free full page ad in show book
- Preferred stalling
- 3 Class Sponsorships
- 1 Championship Class Sponsorship
- Special recognition announcements during show time
- Listed on OABA Web site

- 1 free stall
- Free full page ad in show book
- 2 Class Sponsorships
- Listed on OABA Web site

SILVER SPONSOR: \$250

- 1 free stall
- Free half page ad in show book
- 2 Class Sponsorships
- Listed on OABA Web site

PLATINUM SPONSOR: \$750

- 2 free stalls
- Free full page ad in show book
- Preferred stalling
- 3 Class Sponsorships
- 1 Championship Class Sponsorship
- Special recognition announcements during show time
- Listed on OABA Web site

BRONZE SPONSOR: \$175

- Free business card ad in show book
- 1 Class Sponsorship
- Listed on OABA Web site

CHAMPIONSHIP SPONSOR: \$150

- 1 Championship Class Sponsorship
- Listed on OABA Web site

CLASS SPONSOR: \$100

- 1 Class Sponsorship
- Listed on OABA Web site

GOLD SPONSOR: \$500

The Show Book is 8 1/2" x 11" and will be in black and white. The show book will be presented to all exhibitors, vendors and to the general public attending the show. Prepare your ad in black and white for the Show Book (sponsorships receive a free ad) in jpeg format. All ads must be received by Saturday, October 1, 2011. Contact Reynne Hostetler at hossfamily@aol.com or at 330/935-2837 for details.

Wanted: Ohio Alpaca Owners

We invite all Ohio alpaca owners to join the Ohio Alpaca Breeders Association. Check out our Web site at www.ohioalpacaassociation.com. Be part of one of the largest affiliate organizations of AOBA. See what we've accomplished this year and what we are aiming for in the coming months.

GENERAL HEALTH REQUIREMENTS

1. **All** in-state and out-of-state alpacas must have a Certificate of Veterinarian Inspection (health paper) completed not more than 30 days prior to the last day of the show for each alpaca transported to the show. The certificate to be completed by your veterinarian. Ohio does not require other testing. All alpacas entered in the show must be microchipped. The alpaca's ARI name and microchip number must be included on the Certificate of Veterinarian Inspection (health paper) for each alpaca entered in the show and will be checked upon entering the facility.
2. **Additional health tests required by AOBA for entrance into our show: a negative (BVDV) bovine viral diarrhea virus PCR or VI (VI testing must have been completed prior to 1/1/2010) test. The negative test result must be noted by your veterinarian on the Certificate of Veterinary Inspection.**
3. All Exhibitors are required to provide the Show Superintendent with a photo copy of the original Certificate of Veterinary Inspection that shall be retained in the permanent show records.
4. A representative from OABA will verify and examine health papers.
5. Evidence of infectious or communicable disease, failure to produce the necessary documents for health certification and BVDV testing, or lack of microchip will result in your alpaca being denied entry to the show.

PROMOTE YOUR FARM!

ALPACAFEST 2011 PROGRAM ADVERTISING

Inside Front Cover (8" x 10")	\$1,000
Inside Back Cover (8" x 10")	\$1,000
Full Page (8" x 10")	\$250
Half Page (8" x 5")	\$150
Business Card	\$100

Ad must be the correct size as indicated above and in black and white. Please provide ad by disk or e-mail in jpeg format. Any questions concerning advertising should be directed to Reynne Hostetler at 330/935-2837 or hossfamily@aol.com.
Deadline is Saturday, October 1, 2011.

Show Tips

- Practice with your alpaca. Familiarize having the fleece examined at the shoulder, middle side, and rump. Be prepared to show your alpaca's teeth to the judge.
- Walk your alpaca around before the class to help the animal relax and loosen up. Before the show begins, walk in the ring to get the alpaca used to the surface.
- Be sure that your alpaca's halter fits properly. If you are unsure, ask for help. An alpaca supply vendor will be at the show if you need a halter.
- Do not be afraid to ask for help or advice from your fellow exhibitors; alpaca people are a friendly, helpful bunch.
- Watch the judge. Smile and have fun!

CLASS INFORMATION – FULL FLEECE HUACAYA

Show management will divide or combine as needed as indicated by the 2011 AOBA Show Division Handbook. When filling out the entry forms, please print or type clearly. Color Champion and Reserve Champion Classes available in color groups that have the appropriate number of animals entered.

FULL FLEECE HUACAYA – MALES

CLASS NUMBERS

JUV. YRL. 2–YR+ COLOR

1	2	3	TB – True Black
4	5	6	BB – Bay Black
7	8	9	DB – Dark Brown
10	11	12	MB – Medium Brown
13	14	15	LB – Light Brown
16	17	18	DF – Dark Fawn
19	20	21	MF – Medium Fawn
22	23	24	LF – Light Fawn
25	26	27	BG – Beige
28	29	30	WH – White
31	32	33	CDSG – Classic Dark Silver Grey
34	35	36	CMSG – Classic Medium Silver Grey
37	38	39	CLSG – Classic Light Silver Grey
40	41	42	MDSG – Modern Dark Silver Grey
43	44	45	MMSG – Modern Medium Silver Grey
46	47	48	MLSG – Modern Light Silver Grey
49	50	51	CDRG – Classic Dark Rose Grey
52	53	54	CMRG – Classic Medium Rose Grey
55	56	57	CLRG – Classic Light Rose Grey
58	59	60	MDRG – Modern Dark Rose Grey
61	62	63	MMRG – Modern Medium Rose Grey
64	65	66	MLRG – Modern Light Rose Grey
67	68	69	ID – Indefinite Dark
70	71	72	IL – Indefinite Light
73	74	75	All Multi

(Pinto, Pattern, Appaloosa, Fancy. Use the following codes for “Color” on your Class Entry Form: PN, PT, AP, FN)

FULL FLEECE HUACAYA – FEMALES

CLASS NUMBERS

JUV. YRL. 2–YR+ COLOR

76	77	78	TB – True Black
79	80	81	BB – Bay Black
82	83	84	DB – Dark Brown
85	86	87	MB – Medium Brown
88	89	90	LB – Light Brown
91	92	93	DF – Dark Fawn
94	95	96	MF – Medium Fawn
97	98	99	LF – Light Fawn
100	101	102	BG – Beige
103	104	105	WH – White
106	107	108	CDSG – Classic Dark Silver Grey
109	110	111	CMSG – Classic Medium Silver Grey
112	113	114	CLSG – Classic Light Silver Grey
115	116	117	MDSG – Modern Dark Silver Grey
118	119	120	MMSG – Modern Medium Silver Grey
121	122	123	MLSG – Modern Light Silver Grey
124	125	126	CDRG – Classic Dark Rose Grey
127	128	129	CMRG – Classic Medium Rose Grey
130	131	132	CLRG – Classic Light Rose Grey
133	134	135	MDRG – Modern Dark Rose Grey
136	137	138	MMRG – Modern Medium Rose Grey
139	140	141	MLRG – Modern Light Rose Grey
142	143	144	ID – Indefinite Dark
145	146	147	IL – Indefinite Light
148	149	150	All Multi

(Pinto, Pattern, Appaloosa, Fancy. Use the following codes for “Color” on your Class Entry Form: PN, PT, AP, FN)

- 151 – Huacaya Get of Sire
- 152 – Huacaya Produce of Dam
- 153 – Huacaya Best of Three
- 154 – Huacaya Bred & Owned Yearling Male
- 155 – Huacaya Bred & Owned Yearling Female

CLASS INFORMATION – SHORN HUACAYA

The maximum length shall not exceed 2" on neck and blanket.

SHORN HUACAYA – MALES

CLASS NUMBERS

JUV. YRL. 2-YR+ COLOR

156	157	158	TB, BB – Black Group
159	160	161	DB, MB, LB – Brown Group
162	163	164	DF, MF – Fawn Group
165	166	167	LF, BG – Light Group
168	169	170	W – White Group
171	172	173	DSG, MSG, LSG, DRG, MRG, LRG – Grey Group
174	175	176	IL, ID – Indefinite Group
177	178	179	PT, PN, FN, AP – Multicolor

(Pinto, Pattern, Appaloosa, Fancy. Use the following codes for “Color” on your Class Entry Form: PN, PT, AP, FN)

SHORN HUACAYA – FEMALES

CLASS NUMBERS

JUV. YRL. 2-YR+ COLOR

180	181	182	TB, BB – Black Group
183	184	185	DB, MB, LB – Brown Group
186	187	188	DF, MF – Fawn Group
189	190	191	LF, BG – Light Group
192	193	194	W – White Group
195	196	197	DSG, MSG, LSG, DRG, MRG, LRG – Grey Group
198	199	200	IL, ID – Indefinite Group
201	202	203	PT, PN, FN, AP – Multicolor

(Pinto, Pattern, Appaloosa, Fancy. Use the following codes for “Color” on your Class Entry Form: PN, PT, AP, FN)

CLASS INFORMATION – FULL FLEECE SURI

There are now two divisions for full fleece YEARLING suri males and females.
Please choose the class that matches the length of your YEARLING suri alpaca's fleece.

NEW 2011 SHOW DIVISION RULES FOR SURI MALE AND FEMALE CLASSES:

Yearling 3" – 11" (must have been shorn within 380 days of the first day of scheduled judging):
Minimum of 3" and maximum of 11" on the blanket, neck, and legs.

Yearling 3" – no maximum (not previously shorn or previously shorn beyond 380 days of the first day of scheduled judging): Minimum of 3" and no maximum on the blanket, neck and legs.

FULL FLEECE SURI – MALES

CLASS NUMBERS

JUV. YRL YRL 2-YR+ COLOR

3"-11" 3" no max. 3" min. & no max.

400	401	402	403	TB – True Black
404	405	406	407	BB – Bay Black
408	409	410	411	DB – Dark Brown
412	413	414	415	MB – Medium Brown
416	417	418	419	LB – Light Brown
420	421	422	423	DF – Dark Fawn
424	425	426	427	MF – Medium Fawn
428	429	430	431	LF – Light Fawn
432	433	434	435	BG – Beige
436	437	438	439	WH – White
440	441	442	443	CDSG – Classic Dark Silver Grey
444	445	446	447	CMSG – Classic Medium Silver Grey
448	449	450	451	CLSG – Classic Light Silver Grey
452	453	454	455	MDSG – Modern Dark Silver Grey
456	457	458	459	MMSG – Modern Medium Silver Grey
460	461	462	463	MLSG – Modern Light Silver Grey
464	465	466	467	CDRG – Classic Dark Rose Grey
468	469	470	471	CMRG – Classic Medium Rose Grey
472	473	474	475	CLRG – Classic Light Rose Grey
476	477	478	479	MDRG – Modern Dark Rose Grey
480	481	482	483	MMRG – Modern Medium Rose Grey
484	485	486	487	MLRG – Modern Light Rose Grey
488	489	490	491	ID – Indefinite Dark
492	493	494	495	IL – Indefinite Light
496	497	498	499	All Multi

(Pinto, Pattern, Appaloosa, Fancy. Use the following codes for "Color" on your Class Entry Form: PN, PT, AP, FN)

FULL FLEECE SURI – FEMALES

CLASS NUMBERS

JUV. YRL YRL 2-YR+ COLOR

3"-11" 3" no max. 3" min. & no max.

500	501	502	503	TB – True Black
504	505	506	507	BB – Bay Black
508	509	510	511	DB – Dark Brown
512	513	514	515	MB – Medium Brown
516	517	518	519	LB – Light Brown
520	521	522	523	DF – Dark Fawn
524	525	526	527	MF – Medium Fawn
528	529	530	531	LF – Light Fawn
532	533	534	535	BG – Beige
536	537	538	539	WH – White
540	541	542	543	CDSG – Classic Dark Silver Grey
544	545	546	547	CMSG – Classic Medium Silver Grey
548	549	550	551	CLSG – Classic Light Silver Grey
552	553	554	555	MDSG – Modern Dark Silver Grey
556	557	558	559	MMSG – Modern Medium Silver Grey
560	561	562	563	MLSG – Modern Light Silver Grey
564	565	566	567	CDRG – Classic Dark Rose Grey
568	569	570	571	CMRG – Classic Medium Rose Grey
572	573	574	575	CLRG – Classic Light Rose Grey
576	577	578	579	MDRG – Modern Dark Rose Grey
580	581	582	583	MMRG – Modern Medium Rose Grey
584	585	586	587	MLRG – Modern Light Rose Grey
588	589	590	591	ID – Indefinite Dark
592	593	594	595	IL – Indefinite Light
596	597	598	599	All Multi

(Pinto, Pattern, Appaloosa, Fancy. Use the following codes for "Color" on your Class Entry Form: PN, PT, AP, FN)

- 600 – Suri Get of Sire
- 601 – Suri Produce of Dam
- 602 – Suri Best of Three
- 603 – Suri Bred & Owned Yearling Male
- 604 – Suri Bred & Owned Yearling Female

CLASS INFORMATION – SHORN SURI

The maximum length shall not exceed 3" on neck and blanket.

SHORN SURI – MALES

CLASS NUMBERS

JUV. YRL. 2-YR+

605	606	607
608	609	610
611	612	613
614	615	616
617	618	619
620	621	622
623	624	625
626	627	628

COLOR

TB, BB – Black Group
DB, MB, LB – Brown Group
DF, MF – Fawn Group
LF, BG – Light Group
W – White Group
DSG, MSG, LSG, DRG, MRG, LRG – Grey Group
IL, ID – Indefinite Group
PT, PN, FN, AP – Multicolor

(Pinto, Pattern, Appaloosa, Fancy. Use the following codes for "Color" on your Class Entry Form: PN, PT, AP, FN)

SHORN SURI – FEMALES

CLASS NUMBERS

JUV. YRL. 2-YR+

629	630	631
632	633	634
635	636	637
638	639	640
641	642	643
644	645	646
647	648	649
650	651	652

COLOR

TB, BB – Black Group
DB, MB, LB – Brown Group
DF, MF – Fawn Group
LF, BG – Light Group
W – White Group
DSG, MSG, LSG, DRG, MRG, LRG – Grey Group
IL, ID – Indefinite Group
PT, PN, FN, AP – Multicolor

(Pinto, Pattern, Appaloosa, Fancy. Use the following codes for "Color" on your Class Entry Form: PN, PT, AP, FN)

CLASS INFORMATION – PERFORMANCE CLASSES

CLASS

- 653 Adult Showmanship
(Age 20+ as of 1/1/11)
- 654 Sr. Youth Showmanship
(Age 15-19 as of 1/1/11)
- 655 Int. Youth Showmanship
(Age 12-14 as of 1/1/11)
- 656 Jr. Youth Showmanship
(Age 9-11 as of 1/1/11)
- 657 SubJr. Youth Showmanship
(Under age 9 as of 1/1/11)
- 658 Adult Obstacle
(Age 20+ as of 1/1/11)
- 659 Sr. Youth Obstacle
(Age 15-19 as of 1/1/11)
- 660 Int. Youth Obstacle
(Age 12-14 as of 1/1/11)
- 661 Jr. Youth Obstacle
(Age 9-11 as of 1/1/11)
- 662 SubJr. Youth Obstacle
(Under age 9 as of 1/1/11)
- 663 Adult Public Relations
(Age 20+ as of 1/1/11)
- 664 Sr. Youth Public Relations
(Age 15-19 as of 1/1/11)
- 665 Int. Youth Public Relations
(Age 12-14 as of 1/1/11)
- 666 Jr. Youth Public Relations
(Age 9-11 as of 1/1/11)
- 667 SubJr. Youth Public Relations
(Under age 9 as of 1/1/11)
- 668 Youth Costume
(Age 8-18)

CHAMPIONS CENTER ARENA FLOOR PLAN

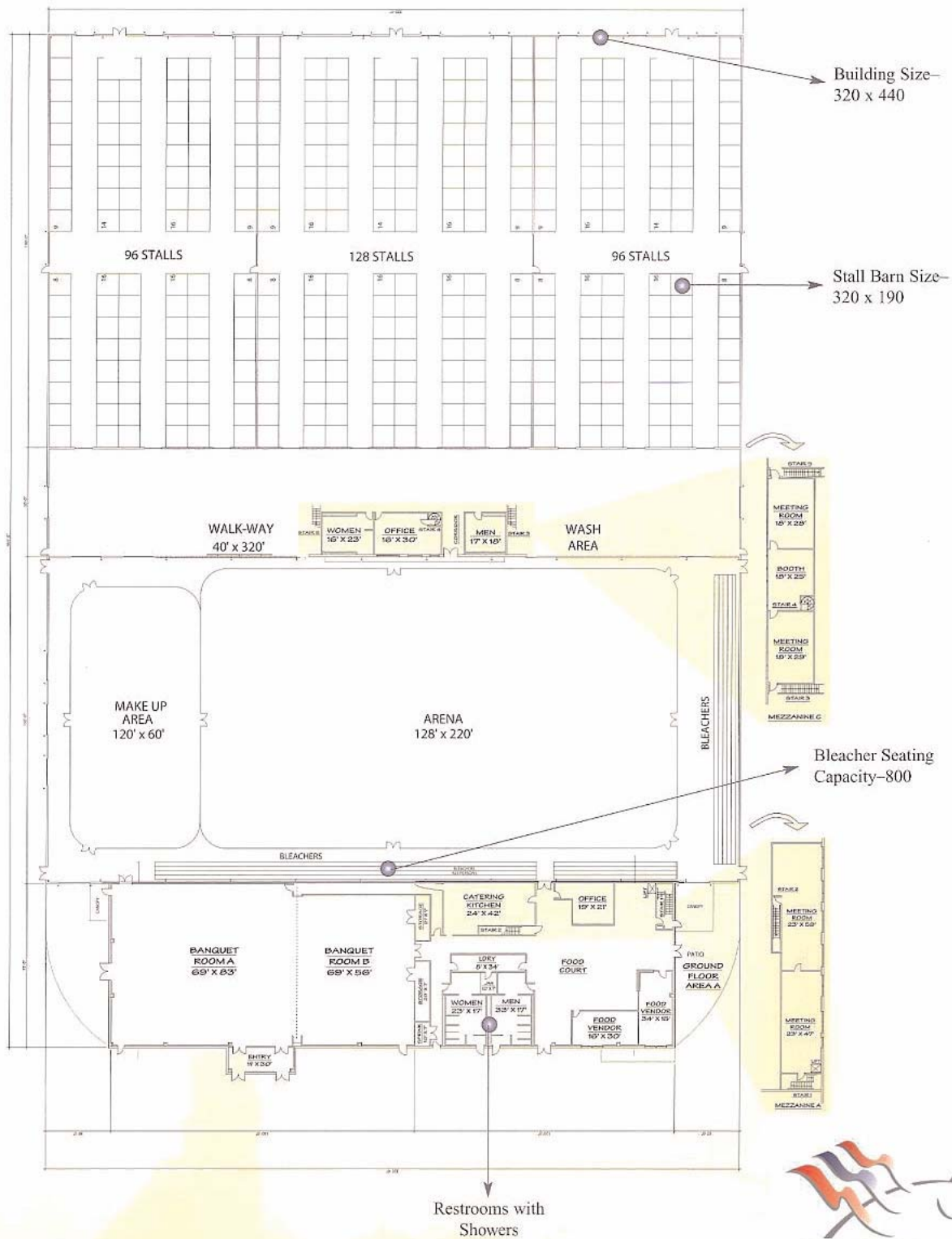

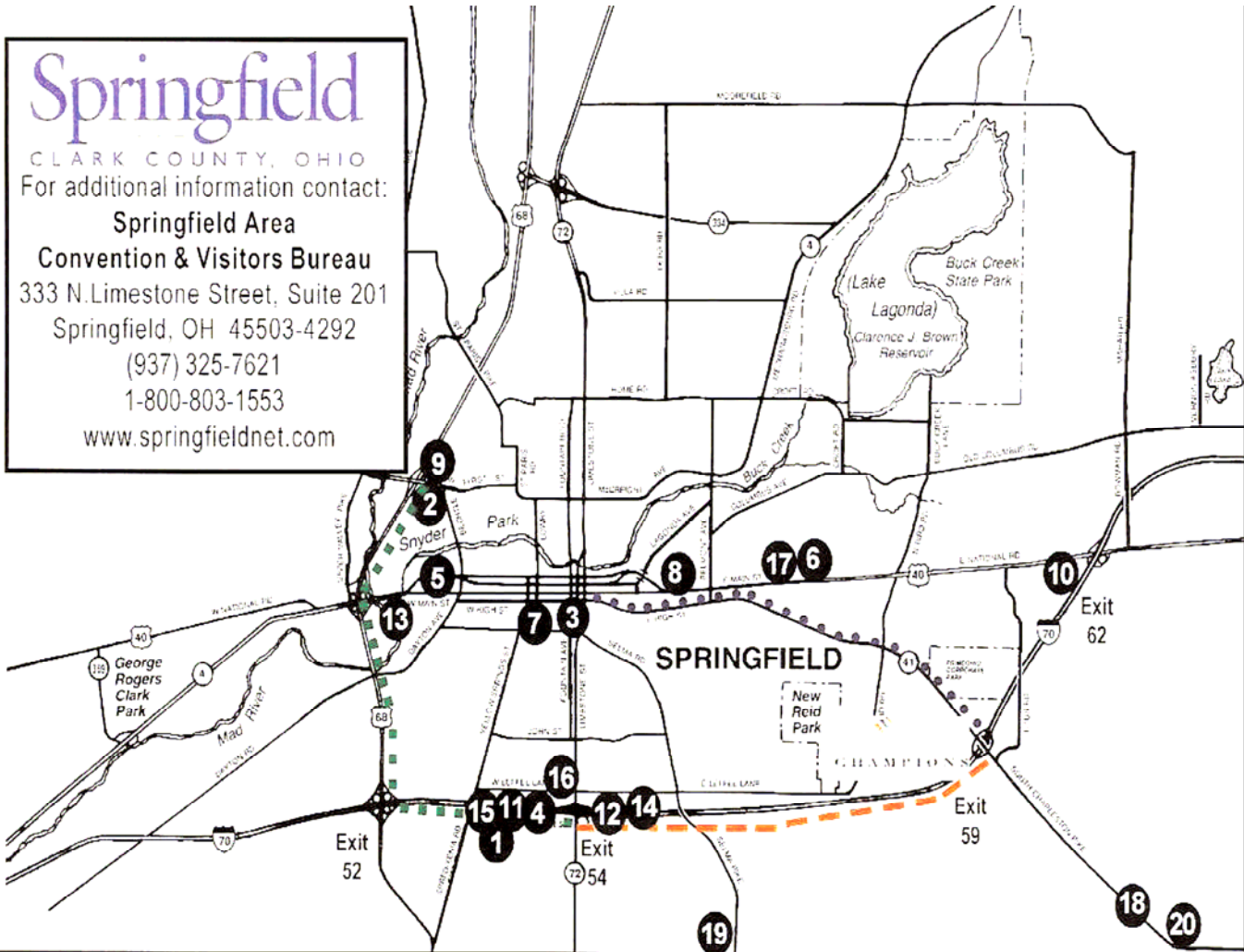

SPRINGFIELD AREA HOTES / MOTELS

- | | | | | | |
|--|---------------------------|--|---------------------------|---|---------------------------|
| 1. Comfort Suites
121 Raydo Circle
5 miles 13 mins from Champions Center | 78 units
937-322-0707 | 8. Fairfax Motel
2418 East Main St | 49 units
937-323-4915 | 15. Red Roof Inn
155 W. Leffel Lane | 58 units
937-325-5356 |
| 2. Country Inn & Suites
1751 W. First St
6 miles 14 mins from Champions Center | 63 units
937-322-2200 | 9. Fairfield Inn
1870 West First St
6 miles 14 mins from Champions Center | 63 units
937-323-9554 | <u>\$69.00</u> | 937-325-5356 |
| 3. Courtyard By Marriott
<u>\$72.00</u> | 124 units | 10. Harmony Motel
4725 East National Rd | 12 unit
937-324-3339 | 16. Super 8 Motel
2 West Leffel Lane | 100 units
937-324-5501 |
| HOST HOTEL
100 S. Fountain Ave
3 miles 8 mins from Champions Center | 937-322-3600 | 11. Hampton Inn
<u>\$81.00</u> | 100 units | 17. Town House Motor Lodge
2850 East Main St | 38 units
937-325-7661 |
| 4. Days Inn
11 West Leffel Lane
5 miles 13 mins from Champions Center | 100 units
937-322-4942 | 12. Quality Inn
383 East Leffel Lane
5 miles 13 mins from Champions Center | 150 units
937-323-8631 | BED & BREAKFASTS | |
| 5. Deluxe Inn
1715 West North St | 129 units
937-324-5561 | 13. Knights Inn
2207 West Main St | 40 units
937-325-8721 | 18. Houstonia Bed & Breakfast | 4 units |
| 6. Drake Motel
3200 East Main St | 28 units
937-325-7334 | 14. Ramada Limited
<u>\$89.95</u> | 46 units | 25 East Mound Street | 888-462-8855 |
| 7. Executive Inn
325 W. Columbia St | 77 units
937-324-5601 | 319 East Leffel Lane
5 miles 13 mins from Champions Center | 937-328-0123 | 19. Victoria Green Plains Farm | 2 units |
| | | | | 8606 Selma Pike | 937-462-8682 |
| | | | | 20. Blackberry Lane | 2 units |
| | | | | 3828 Old Springfield Rd | 937-265-5618 |



Owner of Record for Show Entry Form

(formerly Buyer's Permission to Show Form)

(To be **PRINTED LEGIBLY** or **TYPED** in **BLACK INK**
with **ALL** blank areas below to be completed by the Owner/Seller.)

The undersigned Owner/Seller of the herein stated alpaca, known as:
(Registered Alpaca Name per ARI Registration Certificate)

(Registered Alpaca Name per ARI Registration Certificate)

ARI #: _____ (A Photocopy of ARI Registration Certificate **MUST** be
attached), hereby grants permission to:

Buyer's Name: _____

Buyer's Ranch Name: _____

Address: _____

City: _____ State: _____ Zip: _____ Telephone: _____

to show the above named alpaca in AOBA Certified Shows, to receive "owner" credit for all placing, and to be listed as "owner" in all show programs and results.

This permission is granted effective _____ (month/day/year) and will continue to be in effect unless revoked in writing to the AOBA Show Division Office, 5000 Linbar Dr., Suite 297; Nashville, TN 37211 OR transfer of alpaca is completed, as represented on ARI Registration Certificate.

Owner/Seller Signature: _____ Date: _____

(Must Match ARI Registration Certificate)

Owner/Seller Name per ARI Registration Certificate: _____

Ranch Name: _____

Address: _____

City: _____ State: _____ Zip: _____ Telephone: _____

Distribution and Notes:

1. The Owner/Seller retains the Original signed Owner of Record for Show Entry Form.
2. The Owner/Seller sends a copy of the signed Owner of Record for Show Entry Form and a copy of the ARI Registration Certificate to the Buyer.
3. The Buyer sends a copy of the signed Owner of Record for Show Entry Form and a copy of the ARI Registration Certificate to the AOBA Show Division Office, 5000 Linbar Dr., Suite 297; Nashville, TN 37211.
4. NOTE to Buyer: A copy of this Owner of Record for Show Entry Form must accompany a copy of the ARI Registration Form with every entry into an AOBA Certified Show (Halter, Fleece, Spin-Off, 2-Ounce Sample) which shall be retained by the Show Superintendent with their show records.
5. NOTE to Buyer and Owner/Seller: All revoked Owner of Record for Show Entry Form AOBA Owner of Record for Show Entry Form, will be posted to <http://www.alpacashows.com> under "Owner of Record for Show Entry Form – Revocation List" and will contain the following information: the Registered Name of the Alpaca per ARI Registration Certificate, the alpaca's ARI Registration # (ARI#), the date of revocation, the Owner(s) Name, and the Buyer's Name.
6. NOTE to Show Superintendents: All Halter, Fleece, Spin-Off and 2-Ounce Sample Show Superintendents are required to log onto <http://www.alpacashows.com> and print out a copy of the "Owner of Record for Show Entry Form – Revocation List" prior to each show to ensure compliance with the revocation.

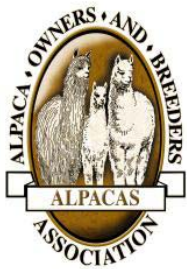

Alpaca Owners and Breeders Association

AOBA Show System

Exhibitor Disclosure Form

Exhibitor Disclosure Form, page 2

(Specific Judging Assignments for your Show to be listed here.)

Nick Harrington – Huacaya Male
Kristin Buhrmann – Huacaya Female
Kath Klay all Suri's
David Barboza - Performance

PLEASE COMPLETE THE FOLLOWING FORM THAT IS PART OF THE SHOW'S INFORMATION ENTRY FORMS:

Exhibitor Disclosure Statement

NAME OF YOUR SHOW
DATES OF YOUR SHOW

AlpacaFest 2011
October 29-30, 2011

____ I, and my immediate family members*, have had a business relationship with (Name of Judge) _____ pursuant to the nine-month period as stipulated in the AOBA Show Handbook. I understand that I, or my immediate family, cannot show in front of this Judge. I understand that I, or my immediate family, cannot show any alpaca in front of this Judge.

____ In accordance with Rules B and C, none of the alpacas I have entered in this show are disqualified from the show ring. None of the alpaca fleeces I have entered in this show are disqualified from the Fleece Show.

____ I, and my immediate family members*, do not have a business relationship with any Judges of the show.

* Immediate family member is defined as: Owner, spouse/domestic partner, parents, children, children's spouse or any other family members living with you.

Important Notice: I understand and agree that failure to report a business relationship with the Judge, showing in front of that Judge if a business relationship exists, or showing any ineligible alpacas/fleeces shall result in a one-year suspension exhibiting at AOBA Certified Shows for me and for my farm(s).

Exhibitor(s) Signature(s)

Printed Name(s) of Exhibitor(s)

Farm Name(s)

Show System Number

Date

Updated: 1/18/2011

Disclaimer: This document was created by Alpaca Owners and Breeders Association for information purposes only and contains proprietary and confidential information. You are notified that all materials contained in this document are protected and exclusive property of Alpaca Owners and Breeders Association and may not be reproduced, republished, distributed, transmitted, displayed, broadcast, or otherwise exploited in any manner without the express written permission of Alpaca Owners and Breeders Association.

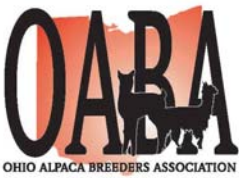

PLEASE NOTE
 Register for the fleece show, fiber arts and spin-off on their own individual entry form.
 Visit OABA's Website at www.ohioalpacaassociation.com to download the forms

REGISTRATION FORM *Alpaca Fest 2011*

Attendee Name(s): _____

(For Name Tags) _____

Farm/Ranch Name: _____

Address: _____

City, State, Zip: _____ Show Division Membership No. _____

Phone: _____ Fax: _____ E-mail: _____

Sharing a stall with: _____

Sponsorship Stalls – used for alpacas stalls	No Charge	X	_____	=	_____
Sponsorship Stalls – used as farm display	No Charge	X	_____	=	_____
Stalls for Sponsors	\$ 99.00	X	_____	=	_____
OABA Members 10' x 10' Stall (panels, bedding & electricity)	\$ 99.00	X	_____	=	_____
Non-OABA Members 10' x 10' Stall (panels, bedding & electricity)	\$ 149.00	X	_____	=	_____
10' x 10' Farm Display Stall	\$ 99.00	X	_____	=	_____
AOBA Nonmember Show Fee (per farm)	\$ 75.00	if applicable		=	_____
Halter Class	\$ 40.00	X	_____	=	_____
Performance Classes	\$ 20.00	X	_____	=	_____
Youth Performance & Costume Classes (one entry fee to enter all youth classes)	\$ 15.00	X	_____	=	_____
Vendor Space 10' x 12'	\$ 149.00	X	_____	=	_____
Get of Sire/Produce of Dam/Breeder's Best Group of Three/ Bred & Owned Yearling/Open Gelding/Non-Breeding Female EACH	\$ 30.00	X	_____	=	_____
Sponsorship (see page 7) Level _____	\$ _____			=	_____
Advertising (see page 8) Size _____	\$ _____			=	_____
Late Animal Entry Fee (<i>All animal entries postmarked after the show deadlines \$ 30.00 will be charged a late fee of \$30 for each animal entry in addition to the normal entry fee.</i>) if applicable	\$ 30.00	X	_____	=	_____
Substitution Fee (<i>for each animal substitution</i>)	\$ 25.00	X	_____	=	_____

Processing Fee (*All incomplete or incorrect entry forms may be assessed \$25 to correct. Please ensure your forms are correct, and please call or e-mail the contact listed on the forms if you have any questions.*) **TOTAL** _____

I will attend the Friday night Meet & Greet dinner. Number of people attending: _____

PLEASE READ AND SIGN

It is understood and agreed that the Ohio AlpacaFest 2011, Champions Center or any of its sponsors, agents or employees shall not be held responsible for any loss, damage or injury to any person, property or animals which is caused directly or indirectly by any reasons. The undersigned also agrees to hold harmless the above parties for any expenses or liabilities incurred, including but not limited to attorney's fees.

Signature of Owner/Exhibitor: _____ Date: _____

Payment by: Check *U.S. funds drawn on U.S. bank) U.S. Money Order MasterCard Visa

Credit Card Number: _____ Exp. Date: _____

Name on Credit Card: _____ Signature: _____

Cancellations made prior to October 21, 2011 will be charged \$40.00 plus \$15.00 per animal. No refunds for cancellations made after October 21, 2011 or for no-shows. **DEADLINE – POSTMARKED ON OR BEFORE OCTOBER 3, 2011**

AlpacaFest 2011
OABA ALAPACAFEST HALTER CLASS ENTRY FORM
 October 29-30, 2011
 Champions Center – Springfield, Ohio

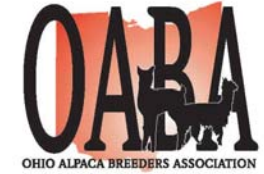

Please make a note with all owners name, if an alpaca is "joint" owned and each owner wants credit in the Show Records as joint ownership.

Owner: _____ Farm/Ranch: _____ AOBA Show Div. #: _____
 Street: _____ City: _____ State: _____ Zip/Postal Code: _____
 Phone: _____ Fax: _____ eMail: _____

Official Use	Color	Class No.	Breed	Alpaca Name (on certificate)	Date of Birth	ARI No.	Gender	Handler	Age if Youth
--------------	-------	-----------	-------	------------------------------	---------------	---------	--------	---------	--------------

YOU MUST INCLUDE WITH EVERY ALPACA ENTERED:

- The above completed Class Entry Form and Registration & Entry Form.
- Payment in full with check made payable to: Ohio Alpaca Breeders Association.
- A copy of the ARI Registration Certificate, Mandatory Exhibitor's Disclosure Form, and Owner of Record Form if applicable.
- Pending Papers cannot be accepted.
- Send to: **Nora Custer-haberbusch, Custer's Alpacas, 3283 Samuel Rd., Akron, OH 44312.** For any question, you may contact Peg Stephens at pegstephens@earthlink.net or 812/294-4880